

MAKE YOUR OWN MICROSCOPE STAND

INSTRUCTION SHEET



MAKERVERSITY DIY

MAKING TOOLS FOR LEARNING

Copyright © Makerversity



Inside net



Fold-under tabs



Slot-in tabs



Component connections



Solid line: Cut



Hatched line: Score



Red line: Cut out slot



Green line: Cut out
component connection

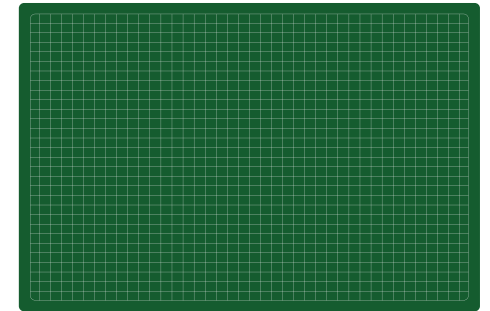

1

FOLD...

Piece 1 ('head') around your webcam, slot the LEDs into place and feed the cable out of the back.

2

BUILD...

Piece 2 ('tube') around the cable and secure it in the back of Piece 1 to make a wand. Piece 2 will hold the webcam in place.

3

CONSTRUCT...

Piece 4 ('neck'). This supports the wand upside down so it can be suspended and adjusted.

Using the key above to help you, cut out all five component nets of your stand. Use a scalpel or scissors, steel ruler and a cutting mat.

To cleanly fold your nets, use the back of your scalpel blade to lightly score over the hatched edges along a metal ruler and fold inwards.

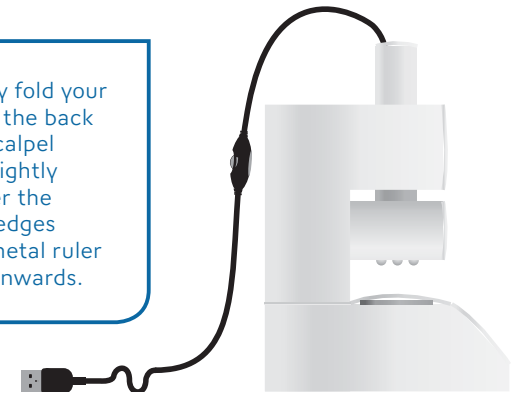

4

WRAP...

Piece 3 ('inner support') in a figure of 8. Fold the base outwards, this will hold it in place in the centre of piece 5 ('base').

5

BUILD...

Piece 5 ('base') around piece 3, with the arch shaped hole facing forward. Feed the upright flaps of piece 3 through the top of piece 5.

6

SLIDE...

The end of piece 4 into the same hole in the top of piece 5 to connect them together. You could add a slide and light into the base.

Bear in mind when folding that all of the striped faces of the nets should be on the inside of your stand once all of your pieces are assembled.

MORE FROM US?
makerversity.education
[@makerversityDIY](https://twitter.com/makerversityDIY)



STEP-BY-STEP
INSTRUCTIONS

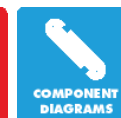

COMPONENT
DIAGRAMS

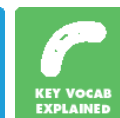

KEY VOCAB
EXPLAINED



TOOL KITS,
HINTS & TIPS